

Tubo Reducción DUR

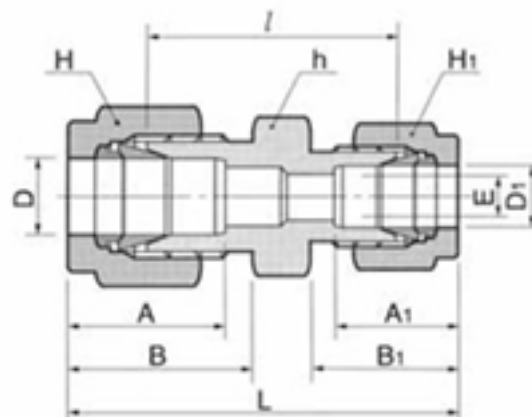

Conector Pulgada

Part No.	Tube O.D.				E Min.
	In	D mm	In	D ₁ mm	
DUR 2-1	1/8	3.18	1/16	1.59	1.27
DUR 3-1	3/16	4.76	1/16	1.59	1.27
DUR 3-2	3/16	4.76	1/8	3.17	2.28
DUR 4-1	1/4	6.35	1/16	1.59	1.27
DUR 4-2	1/4	6.35	1/8	3.17	2.28
DUR 4-3	1/4	6.35	3/16	4.76	3.04
DUR 5-2	5/16	7.93	1/8	3.17	2.28
DUR 5-4	5/16	7.93	1/4	6.35	4.82
DUR 6-1	3/8	9.52	1/16	1.59	1.27
DUR 6-2	3/8	9.52	1/8	3.17	2.28
DUR 6-4	3/8	9.52	1/4	6.35	4.82
DUR 6-5	3/8	9.52	5/16	7.93	6.35
DUR 8-2	1/2	12.70	1/8	3.17	2.28
DUR 8-4	1/2	12.70	1/4	6.35	4.82
DUR 8-6	1/2	12.70	3/8	9.52	7.11
DUR 10-6	5/8	15.87	3/8	9.52	7.11
DUR 10-8	5/8	15.87	1/2	12.70	10.41
DUR 12-4	3/4	19.05	1/4	6.35	4.82
DUR 12-6	3/4	19.05	3/8	9.52	7.11
DUR 12-8	3/4	19.05	1/2	12.70	10.41
DUR 12-10	3/4	19.05	5/8	15.87	12.70
DUR 16-8	1	25.40	1/2	12.70	10.41
DUR 16-12	1	25.40	3/4	19.05	15.74

Conector Métrico

Part No.	Tube O.D.		E Min.
	D	D ₁	
DUR2M-2M	3	2	1.7
DUR6M-2M	6	2	1.7
DUR6M-3M	6	3	2.4
DUR6M-4M	6	4	2.4
DUR8M-6M	8	6	4.8
DUR10M-3M	10	3	2.4
DUR10M-4M	10	4	2.4
DUR10M-6M	10	6	4.8
DUR10M-8M	10	8	6.4
DUR12M-6M	12	6	4.8
DUR12M-8M	12	8	6.4
DUR12M-10M	12	10	7.9
DUR15M-12M	15	12	9.8
DUR16M-10M	16	10	7.9
DUR16M-12M	16	12	9.5
DUR18M-10M	18	10	7.9
DUR18M-12M	18	12	9.5
DUR25M-18M	25	18	15.1
DUR25M-20M	25	20	15.9
DUR30M-18M	30	18	15.1
DUR30M-20M	30	20	15.9
DUR30M-25M	30	25	21.8
DUR32M-18M	32	18	15.1
DUR32M-20M	32	20	15.9
DUR32M-29M	32	25	21.8
DUR38M-20M	38	20	15.9