

Tee Tubo Macho Lateral DTRM-N

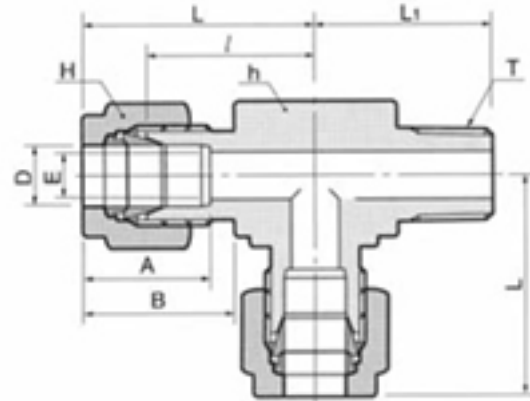

Conector Pulgada NPT

Part No.	Tube O.D.		T NPT	E Min.
	In	mm		
DTRM 1-1N	1/16	1.59	1/16	1.27
DTRM 1-2N	1/16	1.59	1/8	1.27
DTRM 2-2N	1/8	3.17	1/8	2.28
DTRM 2-4N	1/8	3.17	1/4	2.28
DTRM 3-2N	3/16	4.76	1/8	3.04
DTRM 3-4N	3/16	4.76	1/4	3.04
DTRM 4-1N	1/4	6.35	1/16	3.04
DTRM 4-2N	1/4	6.35	1/8	4.82
DTRM 4-4N	1/4	6.35	1/4	4.82
DTRM 4-6N	1/4	6.35	3/8	4.82
DTRM 4-8N	1/4	6.35	1/2	4.82
DTRM 5-2N	5/16	7.93	1/8	4.82
DTRM 5-4N	5/16	7.94	1/4	6.35
DTRM 5-6N	5/16	7.94	3/8	6.35
DTRM 6-4N	3/8	9.52	1/4	7.11
DTRM 6-6N	3/8	9.52	3/8	7.11
DTRM 6-8N	3/8	9.52	1/2	7.11
DTRM 6-12N	3/8	9.52	3/4	7.11
DTRM 8-4N	1/2	12.70	1/4	7.11
DTRM 8-6N	1/2	12.70	3/8	9.65
DTRM 8-8N	1/2	12.70	1/2	10.41
DTRM 8-12N	1/2	12.70	3/4	10.41
DTRM 10-6N	5/8	15.87	3/8	9.65
DTRM 10-8N	5/8	15.87	1/2	11.93
DTRM 10-12N	5/8	15.87	3/4	12.70
DTRM 12-8N	3/4	19.05	1/2	11.93
DTRM 12-12N	3/4	19.05	3/4	15.74

Conector Métrico

Part No.	Tube O.D.		T OT	E Min
	D			
DTRM 3M-2R	3		1/8	2.4
DTRM 3M-4R	3		1/4	2.4
DTRM 4M-2R	4		1/8	2.4
DTRM 4M-4R	4		1/4	2.4
DTRM 6M-2R	6		1/8	4.8
DTRM 6M-4R	6		1/4	4.8
DTRM 6M-6R	6		3/8	4.8
DTRM 6M-8R	6		1/2	4.8
DTRM 8M-2R	8		1/8	4.8
DTRM 8M-4R	8		1/4	6.4
DTRM 8M-6R	8		3/8	6.4
DTRM 8M-8R	8		1/2	6.4
DTRM 10M-2R	10		1/8	4.8
DTRM 10M-4R	10		1/4	7.1
DTRM 10M-6R	10		3/8	7.9
DTRM 10M-8R	10		1/2	7.9
DTRM 12M-2R	12		1/8	4.8
DTRM 12M-4R	12		1/4	7.1
DTRM 12M-6R	12		3/8	9.5
DTRM 12M-8R	12		1/2	9.5
DTRM 12M-12R	12		3/4	9.5
DTRM 16M-6R	16		3/8	9.5
DTRM 16M-8R	16		1/2	11.9
DTRM 16M-12R	16		3/4	12.7
DTRM 18M-8R	18		1/2	11.9
DTRM 18M-12R	18		3/4	15.1
DTRM 20M-8R	20		1/2	11.9
DTRM 20M-12R	20		3/4	15.9