

## Niple Largo Macho NPT GNL

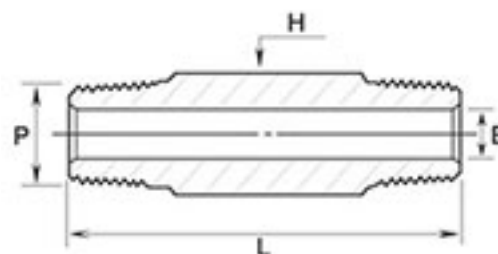

### GNL

Número	P NPT en.	L mm	E mm	H Hex mm
GNL -2N	1/8	-	4.8	11.1
GNL -4N	1/4	-	7.1	14.2
GNL -6N	3/8	-	9.7	17.4
GNL -8N	1/2	-	11.9	22.2
GNL -12N	3/4	-	15.7	26.9
GNL -16N	1	-	22.4	34.9